



ACCOMMODATIONS

348 guestrooms, including 11 suites, 198 kings (60 waterfront kings and 34 city-view corner kings), 129 double / doubles and ten ADA accessible rooms

All Accommodations Offer

- Wireless and wired high-speed Internet access (fee)
- 32-inch LCD flat-screen television with video on demand
- Two dual-line speaker phones equipped for direct data transport
- In-room laptop-sized electronic safe with laptop chargers
- Spacious bathrooms with granite countertops, French doors and hair dryer
- Coffeemaker
- Iron / ironing board
- Daily newspapers available
- Spacious work desk
- Spectacular views of the Delaware River and the downtown Philadelphia skyline

RECREATIONAL FACILITIES

- 24-hour Fitness Center which includes a glass enclosed indoor pool with skylight, outdoor sundeck, stationary and free weight equipment, sauna and changing rooms with showers
- Jogging and walking paths along the Delaware River
- Yoga Away™

LOCATION

Watch history spring to life at the Hilton Philadelphia at Penn's Landing. Take a stroll through time with a visit to the many historic attractions that have made the City of Brotherly Love such a treasured destination. Explore history, culture, entertainment and dining near our luxury hotel

TRANSPORTATION

- Philadelphia Int'l Airport – 11.7 miles / 15 mins

VISITOR INFORMATION

- Language: English
- Currency: USD
- Climate: Summers are typically hot and muggy, fall and spring are generally mild, and winter is cold
- Visas: Please refer to your local travel consultant for visa information prior to travel

POINTS OF INTEREST

- Penn's Landing
- Great Plaza
- Susquehanna Bank Center
- Independence Seaport Museum
- Adventure Aquarium
- Sugarhouse Casino
- Liberty Bell
- Franklin Court
- Elfreth's Alley
- Betsy Ross House
- National Constitution Center
- Independence Hall
- Philadelphia Museum of Art
- Franklin Institute of Science
- The Barnes Foundation
- The Please Touch Museum
- Philadelphia Zoo
- Merriam Theater
- Academy of Music
- Kimmel Center for the Performing Arts

SERVICES & FACILITIES

- In-room dining
- Concierge
- 24-hour business center
- Avis / Budget® car rental
- Attached six-story parking garage with self and valet parking
- Gift shop

RESTAURANTS & BARS

- *Keating's River Grill & Terrace*
- *Perks Cafe*—coffee / snacks

MEETING & EVENT SPACE

- 24,000 square feet of elegant and flexible function space located on two floors
- Beautiful waterfront setting for weddings and events
- The Grand Ballroom, with over 7,400 square feet and 17-foot high ceilings, can be divided into three sections and overlooks the Delaware River.
- The Columbus Ballroom is 3,840 square feet overlooking Columbus Park and the Marina. Ballrooms are located on the second level and open into over 6,500 square feet of prefunction / exhibit space
- Riverview Room with 2,496 square feet and located on the third floor, overlooks the Delaware River and divides into three sections. The Washington Room provides two additional meeting spaces for breakouts and smaller events
- William Penn Boardroom is an Executive Boardroom with seating for 14 and an extended private lounge area



CAPACITY CHART



Room Name	Room Dimensions L x W x H	Room Size Sq. Ft.	Banquet Rds of 10*	Reception	Theater	Classroom 3 per 6'	Boardroom	U-Shape	Hollow Square	Exhibit 8' x 10'
Second Floor										
GRAND BALLROOM	109' x 68' x 17'	7,412	600 / 500	1,000	800	450	—	—	—	46
Grand A	36' x 68' x 17'	2,448	180 / 150	320	260	140	50	48	60	15
Grand B	18' x 68' x 17'	1,224	60 / 50	160	130	60	50	36	24	8
Grand C	18' x 68' x 17'	1,224	60 / 50	160	130	60	50	36	24	8
Grand D	30' x 68' x 17'	2,448	180 / 150	320	260	140	50	48	60	14
Grand AB or CD	54' x 68' x 17'	3,672	300 / 230	480	400	180	50	60	50	20
Grand BC	36' x 68' x 17'	2,448	180 / 150	320	260	120	50	48	50	15
Grand ABC or BCD	72' x 68' x 17'	4,696	420 / 350	650	530	300	—	—	—	26
GRAND BALLROOM FOYER	82' x 34' x 11'	3,788	120 / 100	400	—	—	—	—	—	10
COLUMBUS BALLROOM	96' x 40' x 16'	3,840	310 / 270	400	420	200	—	—	—	22
Columbus A	22' x 40' x 16'	1,280	60 / 60	135	130	60	35	30	40	10
Columbus B	32' x 40' x 16'	1,280	90 / 90	135	130	60	35	30	40	10
Columbus C	32' x 40' x 16'	1,280	90 / 90	135	130	60	35	30	40	10
Columbus AB or BC	64' x 40' x 16'	2,560	220 / 180	270	270	120	70	60	70	20
COLUMBUS FOYER	74' x 40' x 11'	2,960	70 / 70	300	—	—	—	—	—	8
USS NEW JERSEY	28' x 16' x 11'	448	30 / 20	40	26	24	16	15	18	4
USS OLYMPIA	28' x 16' x 11'	448	30 / 20	40	26	24	16	15	18	4

Third Floor

RIVERVIEW ROOM	76' x 32' x 11'	2,496	160 / 150	250	226	150	—	—	—	14
Riverview A	22' x 32' x 11'	704	60 / 50	75	72	45	20	22	24	4
Riverview B	34' x 32' x 11'	1,088	60 / 50	100	84	60	20	22	24	4
Riverview C	22' x 32' x 11'	704	60 / 50	75	72	45	20	22	24	4
Riverview AB or BC	56' x 32' x 11'	1,792	120 / 100	200	150	105	—	—	—	8
WASHINGTON ROOM	46' x 29' x 11'	1,334	70 / 60	140	145	60	38	44	50	6
Washington A	23' x 29' x 11'	667	30 / 30	70	66	24	16	24	30	—
Washington B	23' x 29' x 11'	667	30 / 30	70	66	24	16	24	30	—
WILLIAM PENN BOARDROOM	38' x 24' x 11'	912	— / —	—	—	—	14	—	—	—
EXECUTIVE BOARDROOM	17' x 11' x 11'	187	— / —	—	—	—	10	—	—	—
SUITE 501	—' x —' x 11'	450	40 / 40	30	30	18	14	15	14	—
VIP PARLOR ROOM (WITH FURNITURE)	—' x —' x 11'	620	20 / —	20	20	12	14	—	—	—
JUNIOR PARLOR ROOM	—' x —' x 11'	260	— / —	—	16	—	8	—	—	—
GUEST SLEEPING ROOM	—' x —' x 11'	320	8 / —	—	16	—	8	—	—	—
POOLSIDE (M-F FOR LUNCH)	—' x —' x —'	—	100 / 80	—	—	—	—	—	—	—

**FLOOR PLAN
Second Floor**

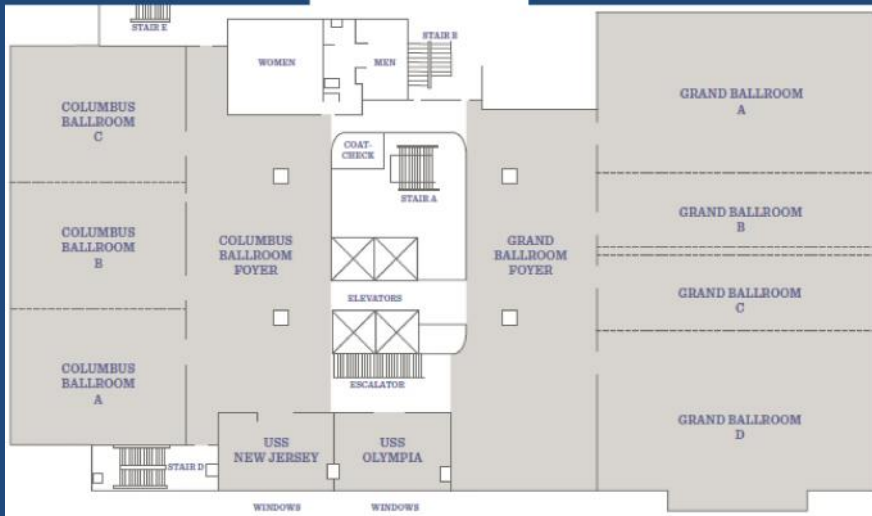

**FLOOR PLAN
Third Floor**

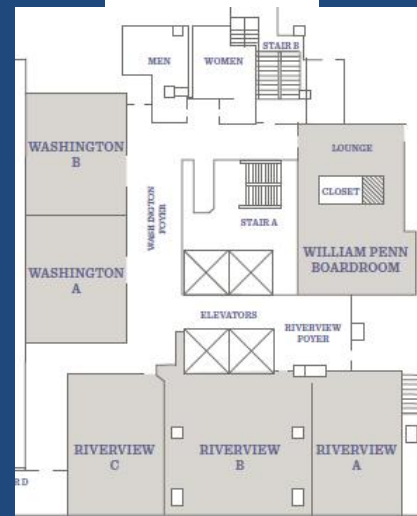

HILTON PHILADELPHIA AT PENN'S LANDING
 201 S. Columbus Boulevard | Philadelphia, PA 19106
 T: +1 215-521-6500 | F: +1 215-521-6600